

53M11-53M12-53M14

CONFINEMENT SERIES

SURFACE LUMINAIRE

CLAMSHELL DESIGN FOR MIN. TO SUPERMAX SECURITY
FLUORESCENT/LED



PROJECT:
TYPE:
PRODUCT:
APPROVED:
DATE:

DIMENSIONAL DATA

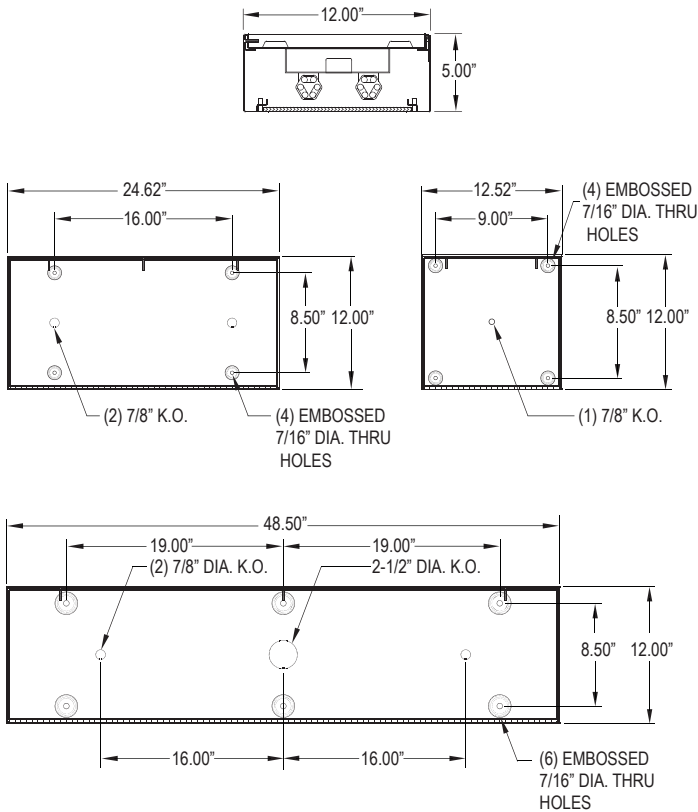

FEATURES

The New Star " 53M11-53M12-53M14 " Confinement clamshell fixture is designed for security application where recessing is not possible or where surface mounting is desired.

- 18-12 gauge die formed steel or stainless steel non-clam shell housing with full length continuous staked piano hinge with welded end.
- Maximum to super maximum security application
- Wide variety of lens options held in place with Z-Channel and weld studs
- Torx head center pin screws standard
- Black neoprene gasket around door frame to prevent light leaks
- Clamshell design incorporates a contraband drop slot gap between the ceiling and the back of fixture
- Optional wet location

APPLICATION

- Confinement
- Psychiatric Wards
- Detention Centers
- Public Housing Complexes
- Transportation Applications
- Athletic Facilities
- Locker Rooms

SPECIFICATION FEATURES

HOUSING:

Die formed, seam welded and, ground smooth (specify material and gauge). Incorporates a removable reflector unitized with all electrical components for easy installation and maintenance.

BACKPLATE:

Die formed with contraband drop slot and embossed mounting holes(materials and gauge to match housing). Security caulking between ceiling and fixture is not required with this back plate design.

HINGE:

16 gauge full length continuous, staked piano hinge, with welded ends. to prevent removal (material to match housing).

LENS / LENS RETENTION:

Lens per specification (see options) and secured by "Z" retainers with weld studs spaced six inches apart for maximum strength.

LED Constant Current:

Available in three standard color temperatures 3500°K,4000°K & 5000°K. Other color temperatures available, consult factory.

LED NIGHT LIGHT:

Integrated switch allows light selection at 100%,70%,40% and 10% levels

GASKET:

Black neoprene gasket around door frame to prevent light leaks

FASTENERS:

Tamper resistant countersunk, flat head Torx screws with center pin reject

FINISH:

White powdercoat finish following an iron phosphate pre-treatment.

LABEL:



ORDERING INFORMATION

Product Family	Gauge	# of Lamps	Lamp Type	# of Ballasts/Drivers	
53M					
53M11 12" x 12-1/2" x 5"	A = 12 Ga. CRS B = 14 Ga. CRS C = 16 Ga. CRS D = 18 Ga. CRS E = 14 Ga. SS F = 16 Ga. SS	G = 18 Ga. SS (Brushed) H = 14 Ga. SS (Painted) J = 16 Ga. SS (Painted) K = 18 Ga. SS (Painted)	Fluorescent: 53M11 1 = 1 Lamp 2 = 2 Lamp 53M12-53M14 2 = 2 Lamp 3 = 3 Lamp LED 53M11: M1 = 1 Modul (15W) M2 = 2 Modul (30W) LED 53M12: L2 = 2 Rw (25W) L3 = 3 Rw (37.5W) LED 53M14: L2 = 2 Rw (50W) L3 = 3 Rw (75W)	53M12 17 = Linear 17W T8 14 = Linear 14W T5 24 = Linear 24W T5 HO 53M14 32 = 32W T8 28 = 28W T5 54 = 54W T5 HO LED: 35 = White 3500°K 40 = White 4000°K 50 = White 5000°K	Fluorescent: 1 = 1 Ballast 2 = 2 Ballast LED: 1 = Driver 2 = Driver

Outer Lens	Inner Lens	Voltage	Options
Ø = No Lens A = .125 Clear Poly. B = .156 Clear Poly. 1 = .187 Clear Poly. 2 = .250 Clear Poly. 3 = .375 Clear Poly.	4 = .500 Clear Poly. 5 = .187 Clear Temp.Glass 6 = .250 Clear Temp.Glass 7 = .375 Clear Temp.Glass ^A 8 = .500 Clear Temp.Glass ^A 9 = .750 Clear Temp.Glass ^A	Ø = No Lens A = .125 Pris. Acrylic B = .125 Pris. Poly. C = .156 Pris. Poly.	D = .187 Pris. Poly. E = .156 Pris. Temp. Glass F = .156 Pris. Acrylic G = .140 DR Acrylic
		12 = 120V 27 = 277V 34 = 347V UN = Universal (120V-277V)	DB = Ballast: Dimming (0-10V) * E1 = Emerg.Ballast (450 Lumens) * E2 = Emerg.Ballast (1350 Lumens) * PR = Program. Rapid Start Ballast AH = Allenhead Screws with center pin reject NL = Fluorescent Night Light *
			LN = LED Night Light. Consult factory for available color /temperatures. FZ = Fuse Holder* WL = Wet Location UV = .005 UV Absorbing Overlay

^A Must Use 12 or 14 Gauge Frame
* Cannot use with universal voltage option

◀ Consult factory for T5 availability
■ Consult factory for lamp-ballast options

