

57L22-57L24

CONFINEMENT SERIES

GRID LUMINAIRE

MINIMUM TO MAXIMUM SECURITY
FLUORESCENT/LED



DIMENSIONAL DATA

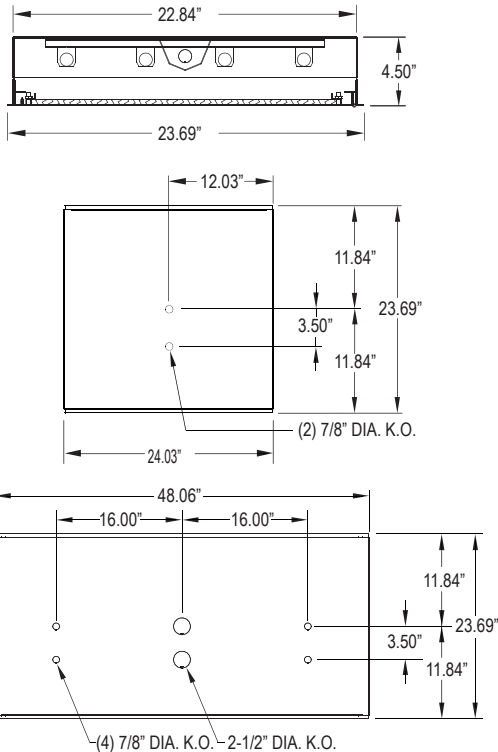

ORDERING INFORMATION

Product Family	Housing	Frame	# of Lamps	Lamp Type
57L_				
57L22 23-11/16" x 24-1/16" x 4-1/2" 57L24 23-11/16" x 48-1/16" x 4-1/2"	B = 14 Ga. CRS C = 16 Ga. CRS D = 18 Ga. CRS E = 14 Ga. SS F = 16 Ga. SS G = 18 Ga. SS H = 14 Ga. SS (Painted) J = 16 Ga. SS (Painted) K = 18 Ga. SS (Painted)	B = 14 Ga. CRS C = 16 Ga. CRS E = 14 Ga. SS (Brushed) F = 16 Ga. SS (Brushed) H = 14 Ga. SS (Painted) J = 16 Ga. SS (Painted)	Fluorescent: 57L22-57L24 2 = 2 Lamp 3 = 3 Lamp 4 = 4 Lamp 6 = 6 Lamp LED 57L22: L2 = LED 2 Rw (25W) L3 = LED 3 Rw (37.5W) L4 = LED 4 Rw (50W) L5 = LED 5 Rw (62.5W) L6 = LED 6 Rw (75W) L7 = LED 7 Rw (87.5W) L8 = LED 8 Rw (100W) LED 57L24: L2 = LED 2 Rw (50W) L3 = LED 3 Rw (75W) L4 = LED 4 Rw (100W) L5 = LED 5 Rw (125W) L6 = LED 6 Rw (150W) L7 = LED 7 Rw (175W) L8 = LED 8 Rw (200W)	Fluorescent: 57L22 17 = Linear 17W T8 32 = Linear 32W T8 14 = Linear 14W T5 28 = Linear 28W T5 24 = Linear 24W T5 54 = Linear 54W T5 HO HO 40 = 40 Twin 2Gx11 LED: (4 lamp only) 57L22-57L24 U6 = 32W U-Lamp ≠ 35 = White 3500° K (6" leg spacing) 40 = White 4000° K 50 = White 5000° K
# of Ballast/Driv.	Outer Lens	Inner Lens	Voltage	Options
Fluorescent: 1 = 1 Ballast 2 = 2 Ballast LED: 1 = Driver 2 = Driver	Ø = No Lens 4 = .500 Clear Poly. A = .125 Clear Poly. 5 = .187 Clear Temp. Glass B = .156 Clear Poly. 6 = .250 Clear Temp. Glass 1 = .187 Clear Poly. 7 = .375 Clear Temp. Glass ^ 2 = .250 Clear Poly. 8 = .500 Clear Temp. Glass ^ 3 = .375 Clear Poly. 9 = .750 Clear Temp. Glass ^	Ø = No Lens A = .125 Pris. Acrylic B = .125 Pris. Polycarbonate C = .156 Pris. Polycarbonate D = .187 Pris. Polycarbonate E = .156 Pris. Tempered Glass F = .156 Pris. Acrylic G = .140 DR Acrylic LC3 = .125 White Frosted Poly.	12 = 120V 27 = 277V 34 = 347V ■ UN = Universal (120V-277V)	DB = Ballast: Dimming (0-10V) * E1 = Emerg. Ballast (450 Lumens) * ◀ E2 = Emerg. Ballast (1350 Lumens) * ◀ EL1 = Emerg. Bat. LED Low EL2 = Emerg. Bat. LED High PR = Program. Rapid Start Ballast AH = Allenhead Screws with center pin reject NL = Fluorescent Night Lgt. * LN = LED Night Light. Consult factory for available color / temp. FZ = Fuse Holder * WL = Wet Location UV = .005 UV Absorbing Overlay

^ Must Use 12 or 14 Gauge Frame
* Cannot use with universal voltage option

◀ Consult factory for T5 availability
≠ 4 lamps only

■ Consult factory for lamp-ballast options



PROJECT: _____

TYPE: _____

PRODUCT: _____

APPROVED: _____

DATE: _____

FEATURES

The New Star " 57L12-57L24 " Confinement grid fixture is designed for recessed security T-Bar ceiling applications

- 18-14 gauge cold rolled or stainless steel
- 16 gauge full length continuous staked piano hinge with welded ends
- Grid security fixture designed for confinement applications and recessed drywall ceiling
- Wide variety of lens options held in place with Z-Channel and weld studs
- Torx head center pin screws standard
- Black neoprene gasket around interior door frame to prevent light leaks.
- Wet location optional

APPLICATION

- Confinement
- Psychiatric Wards
- Detention Centers
- Public Housing Complexes
- Transportation Applications
- Athletic Facilities
- Locker Rooms

SPECIFICATION FEATURES

HOUSING:

Die formed, seam welded, and ground smooth (specify material and gauge). Incorporates a removable reflector unitized with all electrical components for easy installation and maintenance.

FRAME:

Die formed one-piece frame with tightly closed corners. (material and gauge to match housing).

HINGE:

16 gauge full length continuous, staked piano hinge, with welded ends. to prevent removal (material to match housing).

LENS / LENS RETENTION:

Lens per specification (see options) and secured by "Z" retainers with weld studs spaced six inches apart for maximum strength.

ELECTRONICS:

Fluorescent:
Electronic Ballast <10% THD standard. RIF available. Lamps by others.

LED:

Available in three standard color temperatures 3500°K, 4000°K & 5000°K. Other color temperatures available, consult factory.

LED NIGHT LIGHT:

Integrated switch allows light selection at 100%, 70%, 40% and 10% levels

GASKET:

Black neoprene gasket around interior door frame to prevent light leaks.

FASTENERS:

Tamper resistant countersunk, flat head Torx screws with center pin reject

FINISH:

White powdercoat finish following an iron phosphate pre-treatment.

LABEL:



Based on a .125 Clear Polycarbonate outer lens / .125 Prismatic Acrylic Inner lens

# LED BOARDS	# ROWS	WATTAGE	EFFICACY (lm/W)	DELIVERED LUMENS
57L22:				
L2	2 Rw	(25.0W)	115	2,875 LMS
L4	4 Rw	(50.0W)	115	5,750 LMS
L6	6 Rw	(75.0W)	115	8,625 LMS
57L24:				
L2	2 Rw	(50.0W)	115	5,750 LMS
L4	4 Rw	(100.0W)	115	11,500 LMS
L6	6 Rw	(150.0W)	115	17,250 LMS

TAKE AN ADDITIONAL 20% OFF DELEIVERED LUMENS WHEN SPECIFYING THE LC3 LENS