

STARCLEAN 12-14 GRID

CLEANROOM SERIES

GRID LUMINAIRE
FLUORESCENT/LED



PROJECT:
TYPE:
PRODUCT:
APPROVED:
DATE:

DIMENSIONAL DATA

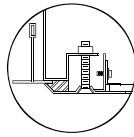
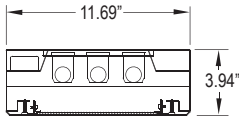

OVERLAPPING FRAME

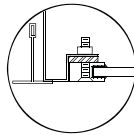
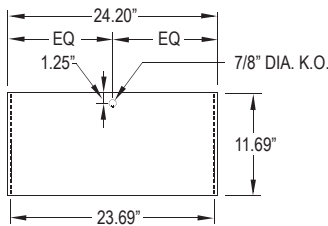

ALUMINUM EXTRUDED
INSET FRAME

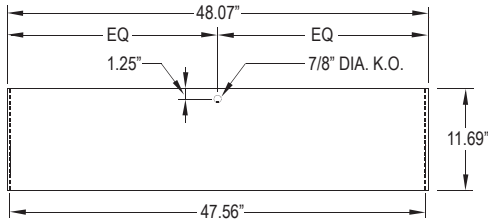

FEATURES

The New Star "StarClean G12-G14" Cleanroom fixture is designed for use in medical settings, labs, high-tech production facilities, food processing and areas where clean is critical.

- Grid housing utilizing enclosed design with seam welds to insure ingress protection
- Standard overlapping frame construction from a single sheet with beveled edges
- Inset frame fabrication from extruded aluminum with sealed, reinforced edges
- Dimming Driver (0-10V) standard
- Dimming 1% available
- Smooth surfaces for easy cleaning
- Specialized gasketing to provide contamination control
- IP65 rated with overlap frame and inset cold rolled steel painted only

APPLICATION

- Cleanroom
- Hospital
- Laboratory
- Food Processing Facilities
- Hi- Technology Manufacturing

SPECIFICATION FEATURES

HOUSING:

20 gauge formed cold rolled steel housing with continuous seam welds. Aluminum and stainless steel option available. Manufactured in accordance with NSF standards.

FRAME:

Inset extruded door available in anodized aluminum or white painted aluminum. Overlapping door frame available in aluminum, CRS and stainless steel. Frame fastened to housing via aircraft cable.

LENS:

Acrylic lens with optional RFI and symmetric/asymmetric pattern, smooth side out. Overlapping frame uses a rail hold down system.

ELECTRONICS:

Fluorescent:
Electronic Ballast <10% THD standard. RIF available. Lamps by others.

LED:

Available in three standard color temperatures 3500°K, 4000°K & 5000°K. Other color temperatures available, consult factory.

LED NIGHT LIGHT:

Integrated switch allows light selection at 100%, 70%, 40% and 10% levels

GASKET:

Closed cell pvc or extruded silicone gaskets prevent air contaminants from entering room.

FASTENERS:

Phillips flat head screws with captive cage nuts

FINISH:

White Antimicrobial powdercoat finish following iron phosphate pre-treatment.

LABEL:



ORDERING INFORMATION

Product Family	Housing Matl.	Frame	# of Lamps	Lamp Type
SCG_				
SCG12 11-11/16" x 24-3/16" x 3-15/16"	HC = 20Ga. CRS (Standard)	Overlap Frame Options: OC = 18Ga. CRS (Standard)	Fluorescent: SCG12-SCF14 2 = 2 Lamp 3 = 3 Lamp	Fluorescent: SCG12 17 = Lin. 17W T8 14 = Lin. 14W T5 24 = Lin. 24W T5 HO
SCG14 11-11/16" x 48-1/16" x 3-15/16"	HS = 20Ga. S.S. (Painted) HP = 20Ga. S.S. (Painted) HA = Alum. (Painted)	Inset Frame Options: IE = Extruded Alum. No IP65 IP = Extruded Alum. (Painted) No IP65 IC = 18Ga. CRS IP65 IA = Alum. (Painted) IP65 IB = 18Ga. S.S. (Brushed) IP65 IS = 18Ga. S.S. (Painted) IP65	LED SCG12: L2 = LED 2 Rw (25W) L3 = LED 3 Rw (37.5W) L4 = LED 4 Rw (50W) LED SCG14: L2 = LED 2 Rw (50W) L3 = LED 3 Rw (75W) L4 = LED 4 Rw (100W)	LED: 35 = White 3500° K 40 = White 4000° K 50 = White 5000° K SCG14 32 = Lin. 32W T8 28 = Lin. 28W T5 54 = Lin. 54W T5 HO
# of Ballasts/Drivers	Lens	Voltage	Options	
1 = 1 Ballast 2 = 2 Ballast LED: 1 = Driver 2 = Driver	A = .125 Prismatic Acrylic B = .125 Prismatic Polycarbonate C = .156 Prismatic Polycarbonate D = .187 Prismatic Polycarbonate LC3 = .125 White Frosted Polycarbonate	12 = 120V 27 = 277V 34 = 347V ■ UN = Universal (120V-277V)	DM1 = Dimming driver 1% SD2 = Step Dim. Module(50-100%)▲ SD3 = Step Dim. Module(25-50-100%)▲ SD3A=Step Dim. Module(33-66-100%)▲ PR = Program Rapid Start FZ = Fuse* NL = Fluorescent Night Light* LN = LED Night Light. Consult factory for available color/temperatures.	
			E1 = Emerg. Bat. Pack (450 Lumens)* ◆◆ E2 = Emerg. Bat. Pack (1100 Lumens)* ◆◆ EL1= Emerg. Bat. LED Low EL2= Emerg. Bat. LED High RF = RIF (Radio Interference Filter)* TH = Torx Head screws (with center pin) TM = Tandem Mount	

* Cannot use with universal voltage option
▲ Consult factory for T5 availability
■ Consult factory for lamp-ballast options

◆ Not available in 277V
◆ Not available in LED



Based lense .250 Clear Polycarbonate/.125 Prismatic Acrylic - 4000K

# LED BOARDS	# ROWS	WATTAGE	EFFICACY (lm/W)	DELIVERED LUMENS
SSG11-SSF11-SSS11				
L1	1 Rw	(12.5W)	110	1,375 LMS
SSG12-SSF12-SSS12 SCG12-SCF12-SCS12:				
L2	2 Rw	(25W)	110	2,750 LMS
L3	3 Rw	(37.5W)	110	4,125 LMS
L4	4 Rw	(50.0W)	110	5,500 LMS
SSG14-SSF14-SSS14 SCG14-SCF14-SCS14:				
L2	2 Rw	(50W)	110	5,500 LMS
L3	3 Rw	(75W)	110	8,250 LMS
L4	4 Rw	(100.0W)	110	11,000 LMS

* TAKE AN ADDITIONAL 20% OFF DELIVERED LUMENS WHEN SPECIFYING THE LC3 LENS