

STARCLEAN M24 GRID

CLEANROOM SERIES

GRID LUMINAIRE

FLUORESCENT/LED/HID



Made in America

PROJECT:
TYPE:
PRODUCT:
APPROVED:
DATE:

DIMENSIONAL DATA

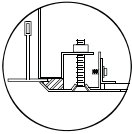
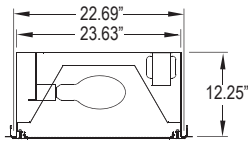

OVERLAPPING FRAME

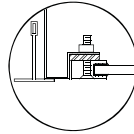

ALUMINUM EXTRUDED INSET FRAME

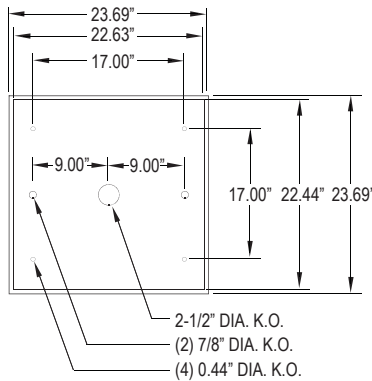

FEATURES

The New Star "StarClean MG24" Cleanroom fixture is designed for use in medical settings, labs, high-tech production facilities, food processing and areas where clean is critical.

- Grid housing utilizing enclosed design with seam welds to insure ingress protection
- Standard overlapping frame construction from a single sheet with beveled edges
- Inset frame fabrication from extruded aluminum with sealed, reinforced edges
- Smooth surfaces for easy cleaning
- Specialized gasketing to provide contamination control

APPLICATION

- Cleanroom
- Laboratory
- Hospital
- Food Processing Facilities
- Hi- Technology Manufacturing

SPECIFICATION FEATURES

HOUSING:

20 gauge formed cold rolled steel housing with continuous seam welds. Aluminum and stainless steel option available. Manufactured in accordance with NSF standards.

FRAME:

Inset extruded door available in anodized aluminum or white painted aluminum. Overlapping door frame available in aluminum, CRS and stainless steel. Frame fastened to housing via aircraft cable.

LENS:

Acrylic lens with optional RFI and symmetric/asymmetric pattern, smooth side out. Overlapping frame uses a rail hold down system.

ELECTRONICS:

Fluorescent:
Electronic Ballast <10% THD standard. RIF available. Lamps by others.

ELECTRONICS:

LED
High power, class 2, LED module available in 3500K, 4000K, and 5000K. HPF LED driver, 120V-277V standard.

LED NIGHT LIGHT:

Integrated switch allows light selection at 100%,70%,40% and 10% levels

GASKET:

Closed cell pvc or extruded silicone gaskets prevent air contaminants from entering room.

FASTENERS:

Phillips flat head screws with captive cage nuts

FINISH:

White Antimicrobial powdercoat finish following iron phosphate pre-treatment.

LABEL:



ORDERING INFORMATION

Product Family	Housing Matl.	Frame	# of Lamps	Lamp Type
SCMG24				
SCMG24 23-11/16" x 23-11/16" x 12-1/4"	HC = 20Ga. CRS (Standard) HS = 20Ga. S.S. HP = 20Ga. S.S. (Painted) HA = Alum. (Painted)	Overlap Frame Options: OC = 18Ga. CRS (Standard) OS = 18Ga. S.S. (Brushed) OP = 18Ga. S.S. (Painted) OA = Alum. (Painted) Inset Frame Options: IE = Extruded Alum. (Painted) IP = Extruded Alum. (Painted)	FLUORESCENT: LED: SCMG24 1 = 1 Lamp 2 = 2 Lamp HID: 1 = 1 Lamp	FLUORESCENT: 42 = 42W Triple Gx24q-4 base 57 = 57W T4 4-Pin Gx24q-5 base 70 = 70W T4 4-Pin Gx24q-6 base LED: 35 = White 3500° K 40 = White 4000° K 50 = White 5000° K HID: 50 = 50W MH - HPS∞ 70 = 70W MH - HPS∞ 100 = 100W MH - HPS∞ 150 = 150W MH - HPS∞ 250 = 250W MH - HPS∞ 400 = 400W MH - HPS∞
Lens	Voltage	Options		
A = .125 Prismatic Acrylic B = .125 Prismatic Polycarbonate C = .156 Prismatic Polycarbonate D = .187 Prismatic Polycarbonate E = .156 Prismatic Tempered Glass + L = .187 Prismatic Tempered Glass +	12 = 120V 27 = 277V 34 = 347V ■ UN = Universal (120V-277V)	DB = Dimming Ballast (0-10V) TH = Torx Head screws(with center pin) PR = Program Rapid Start E1 = Emerg. Bat.(450 Lumens)* FZ = Fuse * E2 = Emerg. Bat.(1100 Lumens)* NL = Fluorescent Night Light ♦* EL1= Emerg. Bat. LED Low LN = LED Night Light. Consult ♦* EL2= Emerg. Bat. LED High factory for available color /temperatures. RF = RIF (Radio Interference Filter) ♦*		

* Cannot use with universal voltage option
 + Must be overlap door
 ■ Consult factory for lamp-ballast options

• Two lamps not available with Emergency Ballast
 ♦ Not available with HID

Notes:

Specifications and Dimensions are subject to change without notice. For additional options and dimensional details please consult your New Star Lighting Representative. For specific electronic ballast, specify brand and catalog number.