

STARCLEAN 16-24 M SURFACE

CLEANROOM SERIES

SURFACE LUMINAIRE
FLUORESCENT / LED / HID



Made in America

| |
|-----------|
| PROJECT: |
| TYPE: |
| PRODUCT: |
| APPROVED: |
| DATE: |

DIMENSIONAL DATA

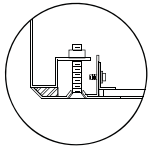
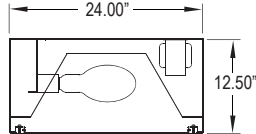
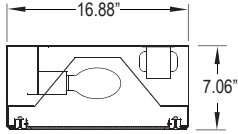

OVERLAPPING FRAME

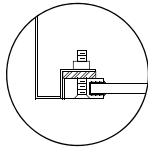

ALUMINUM EXTRUDED
INSET FRAME

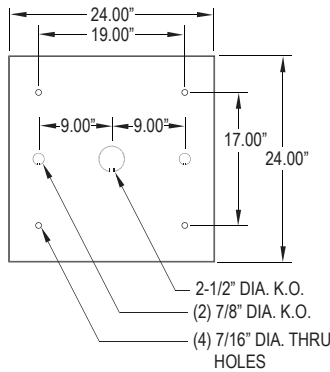
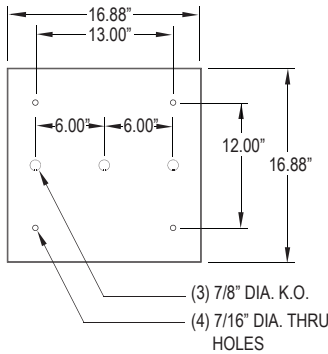

FEATURES

The New Star "StarClean MS16-MS24" Cleanroom fixture is designed for use in medical settings, labs, high-tech production facilities, food processing and areas where clean is critical.

- Surface housing utilizing enclosed design with seam welds to insure ingress protection
- Standard overlapping frame construction from a single sheet with beveled edges
- Inset frame fabrication from extruded aluminum with sealed, reinforced edges
- Specialized gasketing to provide contamination control
- Smooth surfaces for easy cleaning

APPLICATION

- Cleanroom
- Laboratory
- Hospital
- Food Processing Facilities
- Hi- Technology Manufacturing

SPECIFICATION FEATURES

HOUSING:

20 gauge formed cold rolled steel housing with continuous seam welds. Aluminum and stainless steel option available. Manufactured in accordance with NSF standards.

FRAME:

Inset extruded door available in anodized aluminum or white painted aluminum. Overlapping door frame available in aluminum, CRS and stainless steel. Frame fastened to housing via aircraft cable.

LENS:

Acrylic lens with optional RFI and symmetric/asymmetric pattern, smooth side out. Overlapping frame uses a rail hold down system.

ELECTRONICS:

LED High power, class 2, LED module available in 3500K, 4000K, and 5000K. HPF LED driver, 120V-277V standard.

LED NIGHT LIGHT:

Integrated switch allows light selection at 100%,70%,40% and 10% levels

GASKET:

Closed cell pvc or extruded silicone gaskets prevent air contaminants from entering room.

FASTENERS:

Phillips flat head screws with captive cage nuts

FINISH:

White Antimicrobial powdercoat finish following iron phosphate pre-treatment.

LABEL:



ORDERING INFORMATION

| Product Family | Housing Material | Frame | # of Lamps | Lamp Type |
|--|--|---|---|--|
| SCMS - | | | | |
| SCMS16 16-7/8" x 16-7/8" x 7-1/16" | HC = 20Ga. CRS (Standard) HS = 20Ga. S.S. HP = 20Ga. S.S (Painted) HA = Alum. (Painted) | Overlap Frame Options: OC = 18Ga. CRS (Standard) OA = Alum. (Painted) OS = 18Ga. S.S (Brushed) OP = 18Ga. S.S (Painted) Inset Frame Options: IE = Extruded Alum. (Painted) IP = Extruded Alum. (Painted) | FLUORESCENT: SCMS16-SCMS24 1 = 1 Lamp 2 = 2 Lamp HID: 1 = 1 Lamp | LED: SCMS16-SCMS24 L2 = LED 2 Boards (5000lms) L3 = LED 3 Boards (7500lms) |
| SCMS24 24" x 24" x 12-1/4" | | | | FLUORESCENT: SCMS16-SCMS24 42 = 42W Triple Gx24q-4 Bse 57 = 57W T4 4-Pin Gx24q-5 Bse 70 = 70W T4 4-Pin Gx24q-6 Bse LED: 35 = White 3500° K 40 = White 4000° K 50 = White 5000° K |
| | | | | SCMS16 HID: 50 = 50W MH - HPS∞ 70 = 70W MH - HPS∞ 100 = 100W MH - HPS∞ 150 = 150W MH - HPS∞ SCMS24 HID: 150 = 150W MH - HPS∞ 250 = 250W MH - HPS∞ 400 = 400W MH - HPS∞ |

| Lens |
|-----------------------------------|
| A = .125 Prismatic Acrylic |
| B = .125 Prismatic Polycarbonate |
| C = .156 Prismatic Polycarbonate |
| D = .187 Prismatic Polycarbonate |
| E = .156 Prismatic Tempered Glass |

| Voltage |
|----------------------------|
| 12 = 120V |
| 27 = 277V |
| 34 = 347V |
| UN = Universal (120V-277V) |

| Options |
|--|
| DB = Dimming Ballast (0-10v) |
| PR = Program Rapid Start |
| FZ = Fuse * |
| NL = Fluorescent Night Light ♦ |
| LN = LED Night Light. Consult ♦ factory for available color /temperatures. |
| TH = Torx Head screws (with center pin) |
| E1 = Emergency Battery Pack * (450 Lumens) |
| E2 = Emergency Battery Pack * (1100 Lumens) |
| RF = RIF (Radio Interference Filter) ♦ |

- * Cannot use with universal voltage option
- Must be overlap door
- Consult factory for lamp-ballast options

- Two lamps not available with Emergency Ballast
- ♦ Not available with HID
- ▶ Not available in LED

Notes:

Specifications and Dimensions are subject to change without notice. For additional options and dimensional details please consult your New Star Lighting Representative. For specific electronic ballast, specify brand and catalog number.



www.newstarlighting.com

New Star - 4000 S. Bell St. - Chicago, IL 60609 - TEL (773) 847-1400 - FAX (773) 254-6811 - v013