

STARCLEAN 12-14 SURFACE

CLEANROOM SERIES

SURFACE LUMINAIRE
FLUORESCENT/LED



PROJECT:
TYPE:
PRODUCT:
APPROVED:
DATE:

DIMENSIONAL DATA

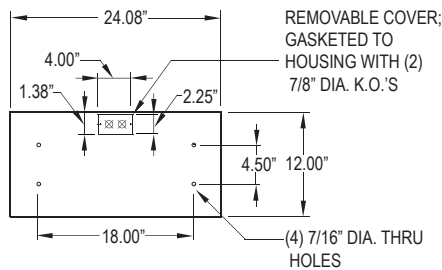
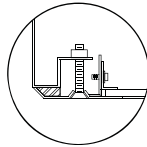
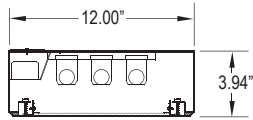

OVERLAPPING FRAME

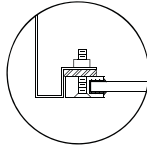

ALUMINUM EXTRUDED INSET FRAME

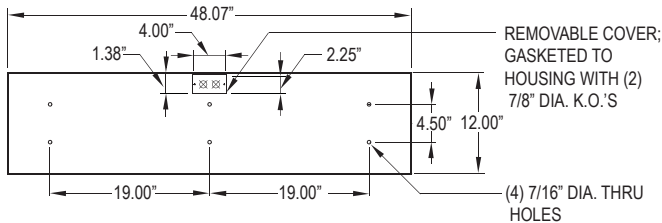

REMOVABLE COVER; GASKETED TO HOUSING WITH (2) 7/8\"/>

FEATURES

The New Star "StarClean S12-S14" Cleanroom fixture is designed for use in medical settings, labs, high-tech production facilities, food processing and areas where clean is critical.

- Surface housing utilizing enclosed design with seam welds to insure ingress protection
- Standard overlapping frame construction from a single sheet with beveled edges
- Inset frame fabrication from extruded aluminum with sealed, reinforced edges
- Dimming Driver (0-10V) standard
- Dimming 1% available
- Smooth surfaces for easy cleaning
- Specialized gasketing to provide contamination control

APPLICATION

- Cleanroom
- Laboratory
- Hospital
- Food Processing Facilities
- Hi- Technology Manufacturing

SPECIFICATION FEATURES

HOUSING:

20 gauge formed cold rolled steel housing with continuous seam welds. Aluminum and stainless steel option available. Manufactured in accordance with NSF standards.

FRAME:

Inset extruded door available in anodized aluminum or white painted aluminum. Overlapping door frame available in aluminum, CRS and stainless steel. Frame fastened to housing via aircraft cable.

LENS:

Acrylic lens with optional RFI and symmetric/asymmetric pattern, smooth side out. Overlapping frame uses a rail hold down system.

ELECTRONICS:

Fluorescent:
Electronic Ballast <10% THD standard. RIF available. Lamps by others.

LED: Constant current

Available in three standard color temperatures 3500°K, 4000°K & 5000°K. Other color temperatures available, consult factory.

LED NIGHT LIGHT:

Integrated switch allows light selection at 100%, 70%, 40% and 10% levels

GASKET:

Closed cell pvc or extruded silicone gaskets prevent air contaminants from entering room.

FASTENERS:

Phillips flat head screws with captive cage nuts

FINISH:

White Antimicrobial powdercoat finish following iron phosphate pre-treatment.

LABEL:



ORDERING INFORMATION

Product Family	Housing Matl	Frame	# of Lamps	Lamp Type
SCS_				
SCS12 12" x 24-1/16" x 3-15/16"	HC = 20Ga. CRS (Standard)	Overlap Frame Options IP65: OC=18Ga. CRS(Stand.) OS=18Ga. S.S.(Brush.) OP=18Ga. S.S.(Paint.) OA=Aluminum (Paint.)	Fluorescent: SCS12-SCS14 2 = 2 Lamp 3 = 3 Lamp LED SCS12: L2 = LED 2 Rw (25W) L3 = LED 3 Rw (37.5W) L4 = LED 4 Rw (50W)	Fluorescent: SSG12: 17 = Lin.17W T8 14 = Lin.14W T5 24 = Lin.24W T5 HO U6 = 32W U-Lamp (6" leg spacing)
SCS14 12" x 48-1/16" x 3-15/16"	HS = 20Ga. S.S. HP = 20Ga. S.S (Painted) HA = Alum. (Painted)	Inset Frame Options: IE=Extruded Alum.No IP65 IP=Extruded Alum.(Paint.) No IP65 IC=18Ga. CRS IP65 IA=Alum.(Paint.) IP65 IB=18Ga. S.S.(Brush.) IP65 IS=18Ga. S.S.(Paint.) IP65	LED SCS14: L1 = LED 1 Rw (25W) L2 = LED 2 Rw (50W) L3 = LED 3 Rw (75W) L4 = LED 4 Rw (100W)	SSG14: 32 = Lin.32W T8 28 = Lin.28W T5 54 = Lin.54W T5 HO LED: 35 = White 3500°K 40 = White 4000°K 50 = White 5000°K

Ballasts/Driver

Fluorescent:	LED:
1 = Ballast	1 = Driver
2 = Ballast	2 = Driver
	3 = Driver
	4 = Driver

Lens

- A = .125 Prismatic Acrylic
- B = .125 Prismatic Polycarbonate
- C = .156 Prismatic Polycarbonate
- D = .187 Prismatic Polycarbonate
- LC3 = .125 White Frosted Poly.
- 5 = .187 Clear Temp.Glass

Voltage

- 12 = 120V
- 27 = 277V
- 34 = 347V
- UN = Universal (120V-277V)

Options

- DM1 = Dimming driver 1%
- SD2 = Step Dim. Module(50-100%)
- SD3 = Step Dim. Module(25-50-100%)
- SD3A=Step Dim. Module(33-66-100%)
- PR = Program Rapid Start
- FZ = Fuse *
- NL = Fluorescent Night Light *
- LN = LED Night Light. Consult factory for available color/temperatures.
- E1 = Emerg. Bat. Pack (450 Lumens) * ◀◀
- E2 = Emerg. Bat. Pack (1100 Lumens) * ◀◀
- EL1= Emerg. Bat. LED Low
- EL2= Emerg. Bat. LED High
- RF = RIF (Radio Interference Filter)*
- TH = Torx Head screws (with center pin)
- TM = Tandem Mount

* Cannot use with universal voltage option
◀ Consult factory for T5 availability
■ Consult factory for lamp-ballast options

▲ Not available in 277V
● 2 lamp only

Notes:
Specifications and Dimensions are subject to change without notice. For additional options and dimensional details please consult your New Star Lighting Representative. For specific electronic ballast, specify brand and catalog number.





Based lense .250 Clear Polycarbonate/.125 Prismatic Acrylic - 4000K

# LED BOARDS	# ROWS	WATTAGE	EFFICACY (lm/W)	DELIVERED LUMENS
SSG11-SSF11-SSS11				
L1	1 Rw	(12.5W)	110	1,375 LMS
SSG12-SSF12-SSS12 SCG12-SCF12-SCS12:				
L2	2 Rw	(25W)	110	2,750 LMS
L3	3 Rw	(37.5W)	110	4,125 LMS
L4	4 Rw	(50.0W)	110	5,500 LMS
SSG14-SSF14-SSS14 SCG14-SCF14-SCS14:				
L2	2 Rw	(50W)	110	5,500 LMS
L3	3 Rw	(75W)	110	8,250 LMS
L4	4 Rw	(100.0W)	110	11,000 LMS

* TAKE AN ADDITIONAL 20% OFF DELIVERED LUMENS WHEN SPECIFYING THE LC3 LENS