

SUD LED

SUD1/SUD2/SUD4

SPECIFICATION FEATURES

- HOUSING:** Die formed, seam welded, and ground smooth cold rolled steel or stainless steel clamshell design. Incorporates a removable reflector unitized with all electrical components for easy installation and maintenance. Angled housing shape designed to withstand physical abuse.
- BACKPLATE:** Die formed with contraband drop slot and embossed mounting holes (material to match housing). Security caulking between ceiling and fixture is not required with this backplate design.
- HINGE:** 16 gauge full length continuous, staked piano hinge with welded ends to prevent removal (material to match housing).
- LENS:** Outer and Inner lens options secured by "Z" retainers with weld studs spaced six inches apart for maximum strength.
- LED:** Available in three color temperatures 3500°K, 4000°K and 5000°K. Other color temperatures available, consult factory. 0-10V dimming available with 10-100% range. Must specify dimming under options.
- FASTENERS:** Tamper resistant countersunk flat head Torx screws with center pin reject.
- FINISH:** White powder coat finish following multistage iron phosphate pre-treatment.
- GASKET:** Black neoprene gasket around door frame to prevent light leaks.

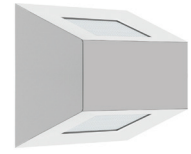

- APPLICATION:** Minimum to Maximum Confinement, Anti-ligature environments, Psychiatric Wards, Public Housing, Detention Centers, Transportation, Athletic Facilities, and more.
- MOUNTING:** Surface Wall installation.
- LABEL:** Fixture is certified to UL standards.



ORDERING INFORMATION

Ex: SUD2-C-LC351C-3/A-UN

PRODUCT FAMILY	NOMINAL SIZE <small>*Dimensional Data Pg. 2</small>	GAUGE	LUMEN** OUTPUT <small>*Performance Data Pg. 2</small>	LAMP TYPE
SUD	1 = 1ft 2 = 2ft 4 = 4ft	B = 14Ga. CRS C = 16Ga. CRS D = 18Ga. CRS E = 14Ga. SS (Brushed) F = 16Ga. SS (Brushed) G = 18Ga. SS (Brushed) H = 14Ga. SS (Painted) J = 16Ga. SS (Painted) K = 18Ga. SS (Painted)	SUD1: LA = 1 Up / 1 Down LE = 0 Up / 1 Down LF = 1 Up / 0 Down SUD2-4 LA = 1 Up / 1 Down LB = 1 Up / 2 Down LC = 2 Up / 2 Down LD = 2 Up / 1 Down LE = 0 Up / 1 Down LF = 1 Up / 0 Down	35 = 3500°K 40 = 4000°K 50 = 5000°K
CIRCUITS	OUTER LENS	INNER LENS	VOLTAGE	OPTIONS
1C = 1 Circuit 2C = 2 Circuits	0 = No Lens A = .125 Clear Poly. B = .156 Clear Poly. 1 = .187 Clear Poly. 2 = .250 Clear Poly. 3 = .375 Clear Poly. 4 = .500 Clear Poly. 5 = .187 Clear Temp. Glass 6 = .250 Clear Temp. Glass 7 = .375 Clear Temp. Glass^ 8 = .500 Clear Temp. Glass^ 9 = .750 Clear Temp. Glass^	0 = No Lens A = .125 Prismatic Acrylic B = .125 Prismatic Poly. C = .156 Prismatic Poly. D = .187 Prismatic Poly. E = .156 Prismatic Temp. Glass F = .156 Prismatic Acrylic G = .140 DR Acrylic LC3 = .125 White Frosted Poly.	12 = 120V 27 = 277V 34 = 347V UN = Universal (120V-277V)	FZ* WL LN UV EL1 EL2 AH DM SL SR

KEY

- FZ = Fuse*
WL = Wet Location
LN = LED Night Light. Integrated switch allows light levels at 100%, 70%, 40%, and 10% levels.
UV = .005 UV Absorbing Overlay
EL1 = Emergency Batt. Low

- EL2 = Emergency Batt. High
AH = Allenhead Screws with center pin reject
DM = 0-10V dimming with 10-100% range
SL = Flush Button Switch (Left)
SR = Flush Button Switch (Right)

- * Cannot use with UN voltage
.. Subject to change
^ Must use with 12Ga. or 14Ga. Frame

Notes:
Specifications and Dimensions are subject to change without notice.

For additional options and dimensional details please consult your New Star Lighting Representative.

DIMENSIONAL DATA

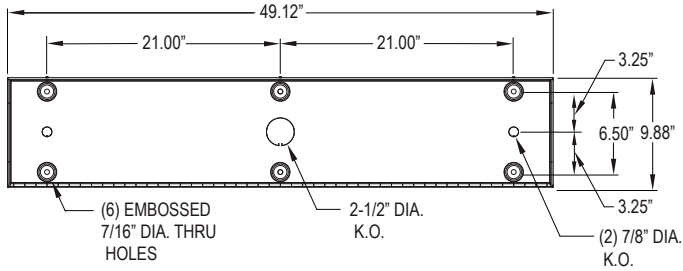
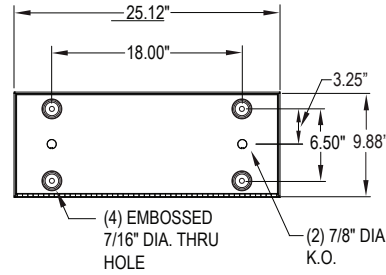
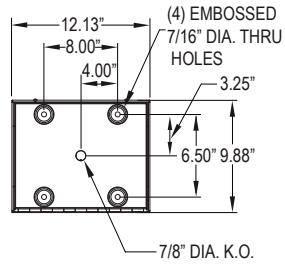
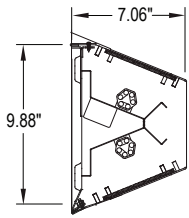

PERFORMANCE DATA

MODEL	OUTPUT	LAMP TYPE	LUMENS DELIVERED	EFFICACY (lm/W)	INPUT POWER (W)
SUD1	LA 1 Up/1 Down	4000°K	4000	87	46
	LE 0 Up/ 1 Down	4000°K	2000	87	23
	LF 1 Up/ 0 Down	4000°K	2000	87	23
SUD2	LA 1 Up/1 Down	4000°K	2750	110	25
	LB 1 Up/ 2 Down	4000°K	4125	110	37.5
	LC 2 Up/2 Down	4000°K	5500	110	50
	LD 2 Up/ 1 Down	4000°K	4125	110	37.5
	LE 0 Up/ 1 Down	4000°K	1375	110	12.5
	LF 1 Up/ 0 Down	4000°K	1375	110	12.5
SUD4	LA 1 Up/1 Down	4000°K	5500	110	50
	LB 1 Up/ 2 Down	4000°K	8250	110	75
	LC 2 Up/2 Down	4000°K	11000	110	100
	LD 2 Up/ 1 Down	4000°K	8250	110	75
	LE 0 Up/ 1 Down	4000°K	2750	110	25
	LF 1 Up/ 0 Down	4000°K	2750	110	25

Notes:
 Specifications and Dimensions are subject to change without notice.
 For additional options and dimensional details please consult your New Star Lighting Representative.

SUD FLUORESCENT

SUD1/SUD2/SUD4

SPECIFICATION FEATURES

- HOUSING:** Die formed, seam welded, and ground smooth cold rolled steel or stainless steel clamshell design. Incorporates a removable reflector unitized with all electrical components for easy installation and maintenance. Angled housing shape designed to withstand physical abuse.
- BACKPLATE:** Die formed with contraband drop slot and embossed mounting holes (material to match housing). Security caulking between ceiling and fixture is not required with this backplate design.
- HINGE:** 16 gauge full length continuous, staked piano hinge with welded ends to prevent removal (material to match housing).
- LENS:** Outer and Inner lens options secured by "Z" retainers with weld studs spaced six inches apart for maximum strength.
- ELECTRONICS:** Electronic Ballast <10% THD standard. Lamps by others.
- FASTENERS:** Tamper resistant countersunk flat head Torx screws with center pin reject.
- FINISH:** White powder coat finish following multistage iron phosphate pre-treatment.
- GASKET:** Black neoprene gasket around door frame to prevent light leaks.

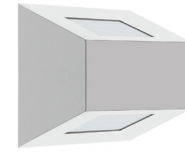

APPLICATION:

Minimum to Maximum Confinement, Anti-ligature environments, Psychiatric Wards, Public Housing, Detention Centers, Transportation, Athletic Facilities, and more.

MOUNTING:

Surface Wall installation.

LABEL:

Fixture is certified to UL standards.



ORDERING INFORMATION

Ex: SUD2-B-D242C-1/0-UN

PRODUCT FAMILY	NOMINAL SIZE <small>*Dimensional Data Pg. 2</small>	GAUGE	# OF LAMPS	LAMP TYPE
SUD	1 = 1ft 2 = 2ft 4 = 4ft	B = 14Ga. CRS C = 16Ga. CRS D = 18Ga. CRS E = 14Ga. SS (Brushed) F = 16Ga. SS (Brushed) G = 18Ga. SS (Brushed) H = 14Ga. SS (Painted) J = 16Ga. SS (Painted) K = 18Ga. SS (Painted)	SUD1: A = 1 Up / 1 Down E = 0 Up / 1 Down F = 1 Up / 0 Down SUD2-4 A = 1 Up / 1 Down B = 1 Up / 2 Down C = 2 Up / 2 Down D = 2 Up / 1 Down E = 0 Up / 1 Down F = 1 Up / 0 Down	SUD1: 18 = 18W Triple Gx24q-2 18Q = 18W Quad G24q-2 26 = 26W Triple Gx24q-3 26Q = 26W Quad G24q-3 32 = 32W Triple Gx24q-3 42 = 42W Triple Gx24q-4 SUD2: 17 = Linear 17W T8 14 = Linear 14W T5 24 = Linear 24W T5 HO 40 = 40 Twin 2Gx11 SUD4: 32 = Linear 32W T8 28 = Linear 28W T5 54 = Linear 54W T5 HO

CIRCUITS	OUTER LENS	INNER LENS	VOLTAGE	OPTIONS
1C = 1 Circuit 2C = 2 Circuit	0 = No Lens A = .125 Clear Poly. B = .156 Clear Poly. 1 = .187 Clear Poly 2 = .250 Clear Poly. 3 = .375 Clear Poly. 4 = .500 Clear Poly. 5 = .187 Clear Temp. Glass 6 = .250 Clear Temp. Glass 7 = .375 Clear Temp. Glass ^ 8 = .500 Clear Temp. Glass ^ 9 = .750 Clear Temp. Glass ^	0 = No Lens A = .125 Prismatic Acrylic B = .125 Prismatic Poly. C = .156 Prismatic Poly. D = .187 Prismatic Poly. E = .156 Prismatic Temp. Glass F = .156 Prismatic Acrylic G = .140 DR Acrylic LC3 = .125 White Frosted Poly.	12 = 120V 27 = 277V 34 = 347V ■ UN = Universal (120V-277V)	DB* E1* ◀ E2* ◀ PR AH NL* FZ* WL UV SL SR

KEY

- DB = Dimming Ballast (0-10V)*
- E1 = Emerg. Ballast (450lm)* ◀
- E2 = Emerg. Ballast (1350lm)* ◀
- PR = Program Rapid Start
- AH = Allenhead Screws with center pin reject
- NL = Fluorescent Night Light*

- FZ = Fuse*
- WL = Wet Location
- UV = .005 UV Absorbing Overlay
- SL = Flush Button Switch (Left)
- SR = Flush Button Switch (Right)

- * Cannot use with UN voltage
- Subject to change
- ◀ Must use with 12Ga. or 14Ga. Frame
- ◀ Consult factory for T5 availability
- Consult factory for lamp-ballast options

Notes:
Specifications and Dimensions are subject to change without notice.
For additional options and dimensional details please consult your New Star Lighting Representative.

DIMENSIONAL DATA

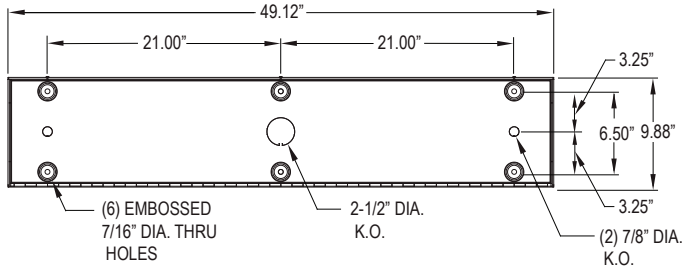
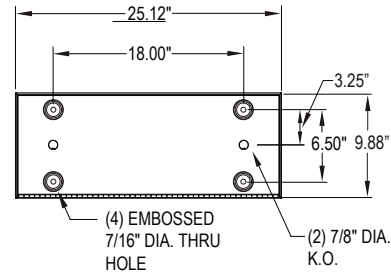
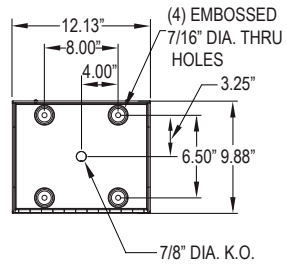
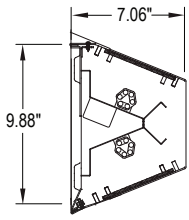

Notes:
 Specifications and Dimensions are subject to change without notice.
 For additional options and dimensional details please consult your New Star Lighting Representative.