

STAR SURGICAL 12-14 SURFACE

HEALTHCARE SERIES
SURGICAL SURFACE LUMINAIRE
FLUORESCENT/LED

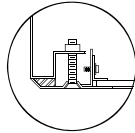

DIMENSIONAL DATA

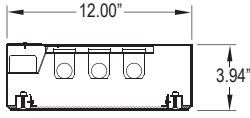

OVERLAPPING FRAME

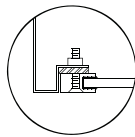
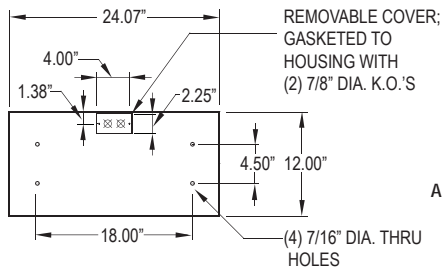

ALUMINUM EXTRUDED INSET FRAME

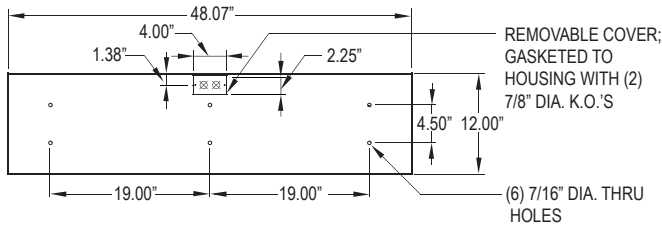

ORDERING INFORMATION

Product Family	Housing Matl	Frame	# of Lamps	Lamp Type
SSS_				
SSS12 12" x 24-1/16" x 3-15/16"	HC = 20Ga. CRS (Standard)	Overlap Frame Options IP65:	Fluorescent: SSS12-SSS14 2 = 2 Lamp 3 = 3 Lamp	SSG12: 17 = Lin.17W T8 14 = Lin.14W T5 24 = Lin.24W T5 HO U6 = 32W U-Lamp • LED: (6" leg spacing) 35 = White 3500° K 40 = White 4000° K 50 = White 5000° K
SSS14 14" x 48-1/16" x 3-15/16"	HS = 20Ga. S.S. HP = 20Ga. S.S. (Painted) HA = Alum. (Painted)	OC=18Ga. CRS(Stand.) OS=18Ga. S.S (Brush.) OP=18Ga. S.S.(Paint.) OA=Aluminum (Paint.)	LED SSS12: L2 = LED 2 Rw (25W) L3 = LED 3 Rw (37.5W) L4 = LED 4 Rw (50W) LED SSS14: L2 = LED 2 Rw (50W) L3 = LED 3 Rw (75W) L4 = LED 4 Rw (100W) L5 = LED 5 Rw (125W) L6 = LED 6 Rw (150W)	SSG14: 32 = Lin.32W T8 28 = Lin.28W T5 54 = Lin.54W T5 HO 35 = White 3500° K 40 = White 4000° K 50 = White 5000° K
		Inset Frame Options: IE=Extruded Alum.No IP65 IP=Extruded Alum.(Paint.) No IP65 IC=20Ga. CRS IP65 IA=Alum.(Paint.) IP65 IB=20Ga. S.S.(Brush.) IP65 IS=20Ga. S.S.(Paint.) IP65	ASMMETRICAL / 2A = 2 Lamp 3A = 3 Lamp	
# Ballasts/Driver	Lens	Voltage	Options	
Fluorescent: 1 = Ballast 2 = Ballast	A = .125 Prismatic Acrylic S = .150 Sym Asymmetric w/RFI Grid Pris. Acrylic (2 or 3 Lamps only) R = .125 Sym. Pris. Acrylic w/ RFI Grid LC3 = .125 White Frosted Polycarbonate	12 = 120V 27 = 277V 34 = 347V ■ UN = Universal (120V-277V)	DM1 = Dimming driver 1% SD2 = Step Dim. Module(50-100%) SD3 = Step Dim. Module(25-50-100%) SD3A=Step Dim. Module(33-66-100%) PR = Program Rapid Start FZ = Fuse * NL = Fluorescent Night Light * LN = LED Night Light. Consult factory for available color/temperatures.	
LED: 1 = Driver 2 = Driver 3 = Driver 4 = Driver			E1 = Emerg. Bat. Pack (450 Lumens) * ◀◆ E2 = Emerg. Bat. Pack (1100 Lumens) * ◀◆ EL1= Emerg. Bat. LED Low EL2= Emerg. Bat. LED High RF = RIF (Radio Interference Filter)* TH = Torx Head screws (with center pin) TM = Tandem Mount	

* Cannot use with universal voltage option ■ Consult factory for lamp-ballast options ◆ Not available in LED
◀ Consult factory for T5 availability ● 2 lamp only

PROJECT: _____

TYPE: _____

PRODUCT: _____

APPROVED: _____

DATE: _____

FEATURES

The New Star "Surgical S12-S14" Healthcare fixture is designed for use in surgical suites, medical settings which employ laminar or turbulent cleanroom airflow and areas where clean is critical.

- Enclosed design to insure ingress protection
- Standard overlapping frame made from single sheet CRS with beveled edges
- Inset frame fabricated from extruded aluminum
- Sealed, reinforced mitered corners
- Gasketed for contamination control
- Smooth surface for minimal maintenance
- Dimming Driver (0-10V) standard
- Dimming 1% available
- Asymmetrical light distribution available
- Lens options for different high tech medical needs
- Accommodates extreme cleaning protocols
- IP65 rated with overlap frame and inset CRS, stainless steel and aluminum painted

APPLICATION

- Operating Rooms
- Isolation Suites
- Hospitals
- Patient Examination Rooms
- Laboratory

SPECIFICATION FEATURES

HOUSING:

20 gauge formed cold rolled steel housing with continuous seam welds. Aluminum and stainless steel option available. Manufactured in accordance with NSF standards.

FRAME:

Inset extruded door available in anodized aluminum or white painted aluminum. Overlapping door frame available in aluminum, CRS and stainless steel. Frame fastened to housing via aircraft cable.

LENS:

Acrylic lens with optional RFI and symmetric/asymmetric pattern, smooth side out. Overlapping frame uses a rail hold down system.

ELECTRONICS:

Fluorescent:
Electronic Ballast <10% THD standard. RIF available. Lamps by others.

LED:

Available in three standard color temperatures 3500° K, 4000° K & 5000° K. Other color temperatures available, consult factory.

LED NIGHT LIGHT:

Integrated switch allows light selection at 100%, 70%, 40% and 10% levels

GASKET:

Closed cell pvc or extruded silicone gaskets prevent air contaminants from entering room.

FASTENERS:

Phillips flat head screws with captive cage nuts

FINISH:

White Antimicrobial powdercoat finish following iron phosphate pre-treatment.

LABEL:



Based on a .125 Prismatic lens

# LED BOARDS	# ROWS	WATTAGE	EFFICACY (lm/W)	DELIVERED LUMENS
SSS11:				
L1	1 Module	(6W)		2,500 LMS
SSS12:				
L2	2 Rw	(25W)	110	2,750 LMS
L3	3 Rw	(37.5W)	110	4,125 LMS
L4	4 Rw	(50W)	110	5,500 LMS
SSS14:				
L2	2 Rw	(50W)	110	5,550 LMS
L3	3 Rw	(75W)	110	8,250 LMS
L4	4 Rw	(100W)	110	11,000 LMS
TAKE AN ADDITIONAL 20% OFF DELEIVERED LUMENS WHEN SPECIFYING THE LC3 LENS				