

AURAMED 22-24 FLUORESCENT

AAS22/AAS24/AAG22/AAG24/AAF22/AAF24

SPECIFICATION FEATURES

- HOUSING:** 20 gauge formed cold rolled steel housing with continuous seam welds. Aluminum and stainless steel option available.
- FRAME:** Inset and overlapping doorframe available in aluminum, cold rolled steel, and stainless steel. Inset extruded door available in anodized aluminum or white painted aluminum. Frame held to housing via aircraft cable.
- LENS:** Clear acrylic lens with smooth side out. Clear polycarbonate lens options available.
- LAMP DIFFUSER:** Perforated metal screen painted white, and lined with .20" thick white acrylic diffuser.
- ELECTRONICS:** Electronic instant start ballast <10% THD standard. Lamps by others.
- FASTENERS:** Philips flat head screws with captive cage nuts.
- GASKET** Closed cell EPDM and closed cell silicone gaskets prevent air contaminations from entering the fixture.
- FINISH:** White antimicrobial powder coat finish following an iron phosphate pre-treatment.



APPLICATION:
Patient Rooms, Hospitals, Examination Rooms, Lobbies, Corridors, and more.

MOUNTING:
Surface, Grid and Flange installation options. Flange fixtures come with adjustable 90° swing arm for easy installation.

LABEL:
Fixture is certified to UL standards. Certified IP65, ISO4, NSF and Damp Location.

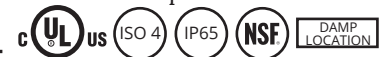

ORDERING INFORMATION

Ex: AAS22-HC/IA-2171C-B-UN

PRODUCT FAMILY	MOUNTING	NOMINAL SIZE <small>*Dimensional Data Pg. 2</small>	HOUSING	FRAME Inset (I) or Overlap (O)	# OF LAMPS
AA	S = Surface G = Grid F = Flange	22 = 2x2 24 = 2x4	HC= 20Ga. CRS (standard) HS= 20Ga. SS (painted) HP= 20Ga. SS (painted) HA= .050Ga. Alum. (painted)	IE=Extruded Alum. ✓ ◆ IP=Extruded Alum. ✓ ◆ (Painted) IP65: IC=20Ga.CRS IA= .050 Alum. (Painted) IB=20Ga.S.S. (Brushed) IS=20Ga.S.S. (Painted) OC=18Ga.CRS (Standard) OS=18Ga.S.S (Brushed) OP=18Ga.S.S. (Painted) OA= .050 Alum.(Painted)	2 = 2 Lamps 3 = 3 Lamps
LAMP TYPE	CIRCUITS	LENS	VOLTAGE	OPTIONS	
2x2: 14 = Lin. 14W T5 17 = Lin. 17W T8 24 = Lin. 24W T5 HO	1C = 1 Circuit 2C = 2 Circuits	A = .125 Clear Acrylic B = .125 Clear Poly. C = .156 Clear Acrylic ◊ D = .156 Clear Poly. ◊ E = .187 Clear Acrylic F = .187 Clear Poly.	12 = 120V 27 = 277V 34 = 347V ■ UN = Universal (120V-277V)	DB E1* ◀ PR E2* ◀ FZ* RF* NL TH TM	
2x4: 28 = Lin. 28W T5 32 = Lin. 32 T8 54 = Lin. 54 T5 HO					

KEY

DB = Dimming Ballast (0-10V)*
PR = Program Rapid Start
FZ = Fuse*
NL = Fluorescent Night Light*

Notes:

Specifications and Dimensions are subject to change without notice.

For additional options and dimensional details please consult your New Star Lighting Representative.

E1 = Emerg. Batt. Pack (450 lm)* ◀
E2 = Emerg. Batt. Pack (1100 lm)* ◀
RF = (RIF) Radio Interference Filter*
TH = Torx Head Screws (w center pin)
TM = Tandem Mount

✓ Not IP65

* Cannot use with UN voltage

◀ Consult factory for T5 availability

■ Consult factory for lamp ballast options

◆ Must use with .156 Acrylic or Poly lens

◊ Can only be used with IE or IP

AURAMED 22-24 FLUORESCENT

AAS22/AAS24/AAG22/AAG24/AAF22/AAF24



DIMENSIONAL DATA

SURFACE MOUNTING

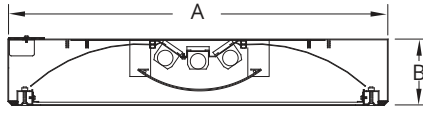

GRID MOUNTING

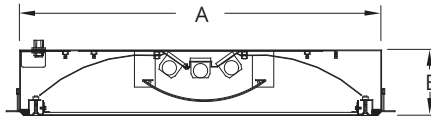

FLANGE MOUNTING

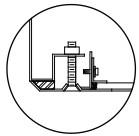
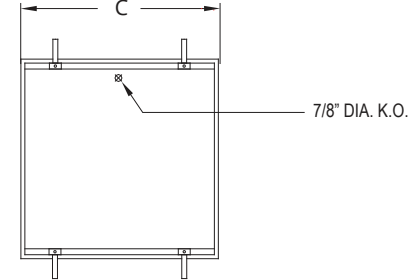
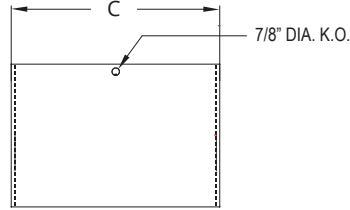
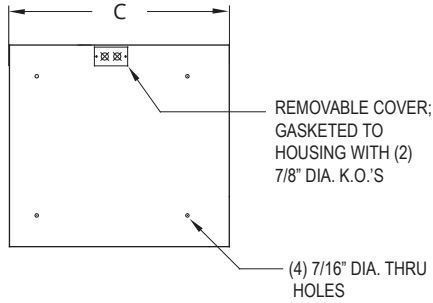
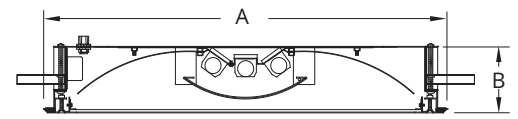

OVERLAPPING FRAME

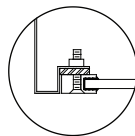

ALUMINUM EXTRUDED INSET FRAME

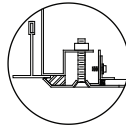

OVERLAPPING FRAME

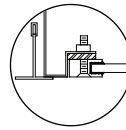

ALUMINUM EXTRUDED INSET FRAME

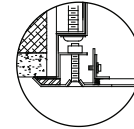

OVERLAPPING FRAME

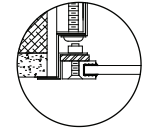

ALUMINUM EXTRUDED INSET FRAME

	A	B	C	Rec. Ceiling Cut-Out
AAS22	24.00"	3.94"	24.07"	-
AAS24	22.00"	3.94"	48.07"	-
AAG22	23.69"	3.94"	24.20"	-
AAG24	23.69"	3.94"	48.07"	-
AAF22	25.13"	3.94"	25.25"	24-3/8" x 24-3/8"
AAF24	25.13"	3.94"	49.13"	48-3/8" x 24-3/8"

Notes:
 Specifications and Dimensions are subject to change without notice.
 For additional options and dimensional details please consult your New Star Lighting Representative.