

STARCLEAN 22-24 FLUORESCENT

SCS22/SCS24/SCG22/SCG24/SCF22/SCF24

SPECIFICATION FEATURES

- HOUSING:** 20 gauge formed cold rolled steel housing with continuous seam welds. Aluminum and stainless steel options available.
- FRAME:** Inset and overlapping doorframe available in aluminum, cold rolled steel, and stainless steel. Extruded inset door available in anodized aluminum or white painted aluminum. Frame held to housing via aircraft cable.
- LENS:** Acrylic lens with smooth side out. Alternate lens options available including Prismatic Polycarbonate and a White Frosted Polycarbonate. Inset (cold rolled steel, stainless steel and .050 alum) and Overlapping frame uses a rail hold down system.
- ELECTRONICS:** Electronic instant start ballast <10% THD standard. Lamps by others.
- FASTENERS:** Stainless steel Philips flat head screws with captive cage nuts. Finish to match housing.
- FINISH:** White antimicrobial powder coat finish following multistage iron phosphate pre-treatment.
- GASKET:** Closed cell EPDM and closed cell silicone gaskets prevent air contaminations from entering the fixture.



APPLICATION:

Cleanroom, Hospital, Hi-Tech Manufacturing, Laboratory, Food Processing Facilities, Commercial Kitchens, and more.

MOUNTING:

Surface, Grid or Flange mounting. Flange fixtures come with adjustable 90° swing arm for easy installation. Optional Yoke Bracket would replace swing arm. Grid fixtures compatible with 1-1/2" and 15/16" Grid systems. Mounting for custom ceilings available, consult factory.

LABEL:

Fixture is certified to UL standards. Certified IP65, ISO4, and NSF.



ORDERING INFORMATION

Ex: SCG24-HS/IC-3322C-B-UN-PR

PRODUCT FAMILY	MOUNTING	NOMINAL SIZE (Dimensional Data Pg. 2)	HOUSING	FRAME Inset (I) or Overlap (O)	# OF LAMPS
SC	S = Surface G = Grid F = Flange	22 = 2x2 24 = 2x4	HC = 20Ga. CRS (standard) HS = 20Ga. SS (Brushed) HP = 20Ga. SS (painted) HA = .050Ga. Alum. (painted)	IE=Extruded Alum. ✓ ◆ IP=Extruded Alum. ✓ ◆ (Painted) IP65: IC=20Ga.CRS IA= .050 Alum. (Painted) IB=20Ga.S.S. (Brushed) IS=20Ga.S.S. (Painted) OC=18Ga.CRS (Standard) OS=18Ga.S.S (Brushed) OP=18Ga.S.S. (Painted) OA= .050 Alum. (Painted)	2 = 2 Lamps 3 = 3 Lamps 4 = 4 Lamps 6 = 6 Lamps
LAMP TYPE	CIRCUITS	LENS	VOLTAGE	OPTIONS	
2x2: 14 = Lin. 14W T5 17 = Lin. 17W T8 24 = Lin. 24W T5 HO	1C = 1 Circuit 2C = 2 Circuits	A=.125 Prismatic Acrylic B=.125 Prismatic Poly. C=.156 Prismatic Poly. D=.187 Prismatic Poly. Ø E=.125 White Frosted Poly. G=.140 DR Acrylic	12 = 120V 27 = 277V 34 = 347V ■ UN = Universal (120V-277V)	E1* ◀ IP66 E2* ◀ TM+ RF* DB* TH PR FY FZ*	
2x4: 28 = Lin. 28W T5 32 = Lin. 32W T8 54 = Lin. 54W T5 HO					

KEY

- E1 = Emerg. Battery Pack (450 Lumens)* ◀
E2 = Emerg. Battery Pack (1100 Lumens)* ◀
RF = RIF (Radio Interference Filter)*
TH = Torx Head screws (with center pin)
FY = Yoke Bracket for Flange mount
(Replace swing arm system)

- IP66 = IP66 rating (only with Overlapping Frame) ✓
TM = Tandem Mount+
DB = Dimming Ballast*
PR = Program Rapid Start
FZ = Fuse*

- ◆ Not IP65
◆ Cannot be used with .187 Prismatic Poly
Ø Cannot be used with IE or IP
* Cannot use with UN voltage
+ Requires joiner bracket. Supplied with fixture.
■ Consult factory for lamp-ballast options
◀ Consult factory for T5 availability

Notes:
Specifications and Dimensions are subject to change without notice.
If circuit is not specified at time of quote or order, fixture will have single circuit.

STARCLEAN 22-24 FLUORESCENT

SCS22/SCS24/SCG22/SCG24/SCF22/SCF24



DIMENSIONAL DATA

SURFACE MOUNTING

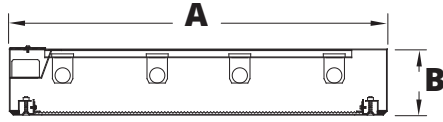

GRID MOUNTING

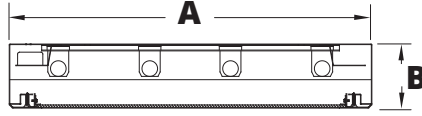

FLANGE MOUNTING

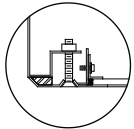
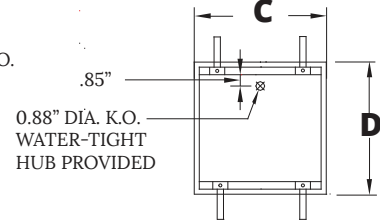
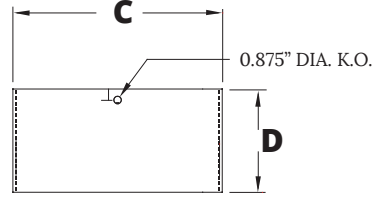
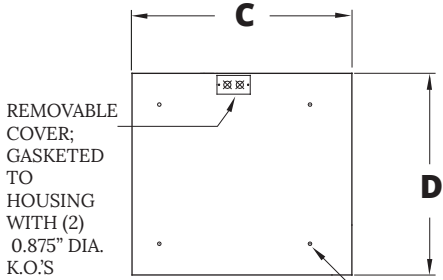
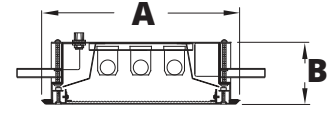

OVERLAPPING FRAME ALUMINUM EXTRUDED INSET FRAME

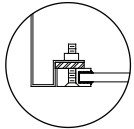

(4) .4375" DIA. THRU HOLES

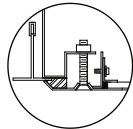

OVERLAPPING FRAME ALUMINUM EXTRUDED INSET FRAME

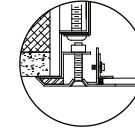
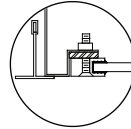

OVERLAPPING DOOR ALUMINUM EXTRUDED INSET DOOR

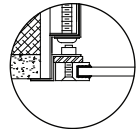

	A	B	C	D	Recommended Ceiling Cut-Out
SCS22	24"	3.94"	24.07"	24"	N/A
SCS24	24"	3.94"	48.07"	24"	N/A
SCG22	23.69"	3.94"	24.07"	23.69"	N/A
SCG24	23.69"	3.94"	48.07"	23.69"	N/A
SCF22	25.13"	3.94"	25.25"	25.13"	24.375" x 24.375"
SCF24	25.13"	3.94"	49.13"	25.13"	48.375" x 24.375"

(SCG) GRID COMPATIBILITY:

Spaced at 24" x 48" Centers

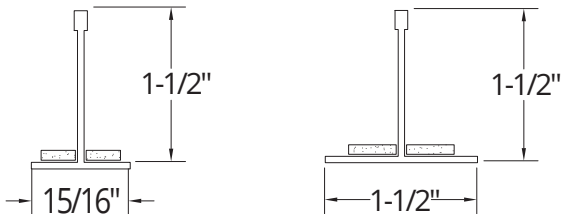

Notes:
Specifications and Dimensions are subject to change without notice.
For additional options and dimensional details please consult your New Star Lighting Representative.