

PRIMO LED SERIES

PR4G/PR4F

SPECIFICATION FEATURES

HOUSING: 20 gauge formed cold rolled steel housing with continuous seam welds. Aluminum and stainless steel options available.

FRAME: Optional inset or overlapping frame available in aluminum, cold rolled steel, and stainless steel.

LENS: Ribbed white or clear polycarbonate lens.

LED: Available in three color temperatures 3500°K, 4000°K and 5000°K. Other color temperatures available, consult factory. 0-10V dimming available with 10-100% range. Must specify dimming under options.

FASTENERS: Stainless steel Philips flat head screws with captive cage nuts. Finish to match housing.

FINISH: White antimicrobial powder coat finish following multistage iron phosphate pre-treatment.

GASKET: Closed cell EPDM and closed cell silicone gaskets prevent air contaminations from entering the fixture.



APPLICATIONS: Patient Rooms, Exam Rooms, Recovery Areas, Skilled Nursing and more. Typically used in pairs adjacent to patient bed. Sold as a single unit.

MOUNTING: Grid or Flange mounting. Flange fixtures come with 2 yokes.

LABEL: Fixture is certified to UL standards by Intertek Testing Laboratories.



ORDERING INFORMATION

Example: PR4G-HC/OC-L140-L240-2C-RW-RI-UN

SERIES	SIZE	MOUNTING	HOUSING	OPTIONAL FRAME*	AMBIENT	
					LUMEN OUTPUT*	LAMP TYPE
PR	4				L1	
	4 = ft	G = Grid F = Flange	HC = 20Ga. CRS Painted HS = 20Ga. SS Brushed HP = 20Ga. SS Painted HA = 16Ga. Alum. Painted	Blank = No Frame INSET (I) or OVERLAP (O) OC = 18Ga. CRS Painted OS = 18Ga. SS Brushed OP = 18Ga. SS Painted OA = 16Ga. Alum Painted IC = 20Ga. CRS Painted IA = 16Ga. Alum Painted IB = 20Ga. SS Brushed IS = 20Ga. SS Painted	L1 = Standard	35 = 3500°K 40 = 4000°K 50 = 5000°K

*Nominal Size.
Dimensional Data on
Page 2

*Subject to change. Data on
Page 2

* Frame provides sealed fixture for ease
of cleanability. Frame lens is a .125 Clear
Poly. unless otherwise specified.

EXAM		CIRCUITS	LENS*	READING LIGHT*	VOLTAGE	OPTIONS
LUMEN OUTPUT*	LAMP TYPE					
L2						
L2 = Standard	35 = 3500°K 40 = 4000°K 50 = 5000°K	1C = 1 Circuit 2C = 2 Circuits	RW = Ribbed White Poly. RC = Ribbed Clear Poly.	Blank = None RI = LED Integral RD = LED Detached	12 = 120V 27 = 277V 34 = 347V UN = Universal (120V-277V)	FZ = Fuse* DM = 0-10V dimming with 10-100% range 90C = 90 CRI for Ambient & Exam only LV = Low Voltage Controller** EL1 = Emerg. Batt Low*** RF = (RIF) Radio Interference Filter** LN = LED Night Light (3000°K standard)

*Subject to change. Data
on Page 2

*Lens option for inner diffuser.
If frame is selected, frame lens
is a .125 Clear Poly. unless
otherwise specified.

*See page 2 for details.

* Cannot use with UN voltage
** Cannot use with UN or 347V
*** Cannot use with 347V

PERFORMANCE DATA*

MODEL	FUNCTION	OUTPUT	LAMP TYPE	LUMENS DELIVERED	EFFICACY (lm/W)	INPUT POWER (W)
PR4	Ambient (without Reading Light)	Standard	3500°K	2200	88	25
			4000°K	2350	94	25
			5000°K	2500	100	25
	Exam (without Reading Light)	Standard	3500°K	4250	85	50
			4000°K	4550	91	50
			5000°K	4850	97	50
	Ambient (with Reading Light Integral)	Standard	3500°K	1700	90	19
			4000°K	1820	96	19
			5000°K	1940	102	19
	Exam (with Reading Light Integral)	Standard	3500°K	3300	87	38
			4000°K	3530	93	38
			5000°K	3760	99	38
Detached Reading Light			3000°K	200	57	3.5

Displayed information is with the Ribbed White Poly lens. *Subject to change without notice. Visit www.newstarlighting.com for additional information and IES files.

DIMENSIONAL DATA



Fixture without Reading Light

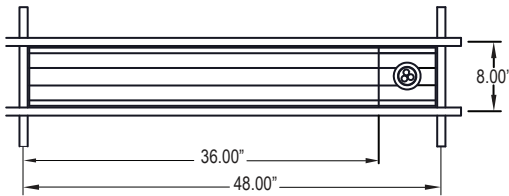

Fixture with Integral Reading Light (RI)

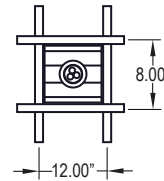

Stand Alone Reading Light (PRRD)
* Can be ordered separately, consult factory

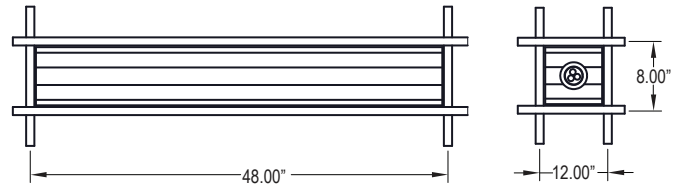

Fixture with Detached Reading Light (RD)

GRID MOUNTING

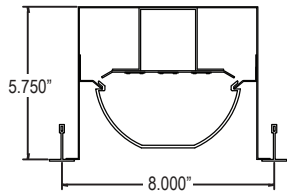

CROSS SECTION WITHOUT DOOR

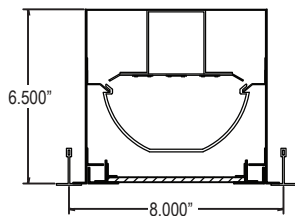

CROSS SECTION WITH DOOR

FLANGE MOUNTING

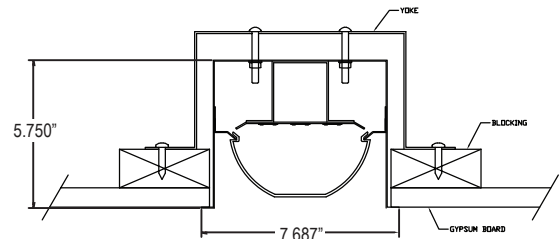

CROSS SECTION WITHOUT DOOR

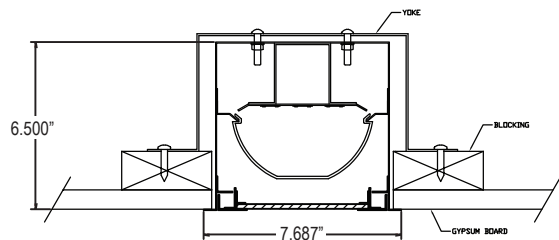

CROSS SECTION WITH DOOR

Notes:
Specifications and Dimensions are subject to change without notice.
For additional options and dimensional details please consult your New Star Lighting Representative.