

SPECIFICATION FEATURES

HOUSING: 20 gauge formed cold rolled steel housing seam welded and ground smooth (standard). Stainless steel or aluminum option available.

FRAME: Inset and overlapping doorframe available in aluminum, cold rolled steel, and stainless steel.

LENS: Ambient and Exam lens available in Prismatic Acrylic, Prismatic Polycarbonate and White Frosted Polycarbonate.

LED: Available in three color temperatures 3500°K, 4000°K and 5000°K with maximum 3-step MacAdam variation allowance. Other color temperatures available, consult factory. Minimum 80 CRI standard with optional minimum 90 CRI available for ambient and exam only.

DRIVER: 0-10V dimming available with 10-100% range and 1-100% range for ambient and night light (if night light is selected). Must specify dimming under options. Ambient and Exam compartments default to 2 circuits (1 Ambient, 1 Exam) unless otherwise specified. Reading and/or Night Light supplied with an additional independent circuit.

FASTENERS: Stainless steel Philips flat head screws with captive cage nuts. Finish to match doorframe.

FINISH: White antimicrobial powder coat finish following multistage iron phosphate pre-treatment on all exposed room-side painting surfaces, unless otherwise specified.

GASKET: Closed cell EPDM and closed cell silicone gaskets prevent air contaminations from entering the fixture.

LOW VOLTAGE CONTROLLER: One low voltage controller per pair is recommended. CPP-R (Right) includes the integral low voltage controller for the pair.



APPLICATIONS: Patient Rooms, Exam Rooms, Recovery Areas, Skilled Nursing and more. Typically used in pairs adjacent to patient bed. Sold as a single unit. Must order a "Left" and a "Right" for a complete pair.

MOUNTING: Grid or Flange installation. Flange fixtures are shipped with yoke and hardware to mount yoke to fixture.

LABEL: Fixture is certified to UL standards by Intertek Testing Laboratory.



DIMENSIONAL DATA

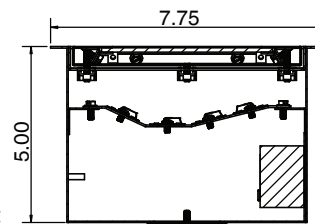
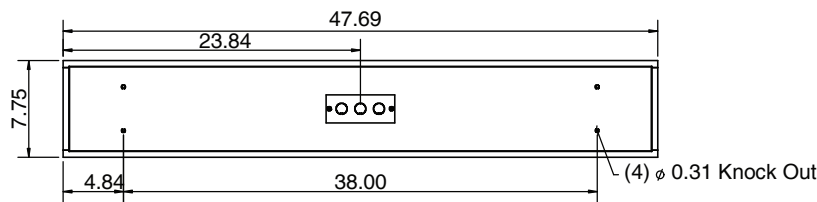
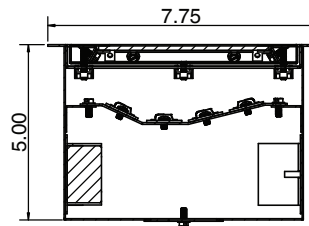
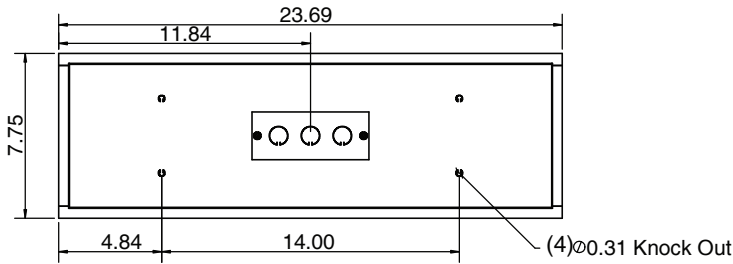

Notes:
Specifications and Dimensions are subject to change without notice.
For additional options and dimensional details please consult your New Star Lighting Representative.

COMPRO SERIES LED

CPPG2/CPPF2/CPPG4/CPPF4

ORDERING INFORMATION

Example: CPPG4R-HC/OC-L140-L2352C-A-RI-LN-UN

SERIES	MOUNTING	SIZE	POSITION	HOUSING	FRAME	AMBIENT LUMEN OUTPUT*	AMBIENT COLOR TEMP.
CPP						L1	
	G = Grid F = Flange*	2 = 2ft. 4 = 4ft.	L = Left R = Right	HC = 20Ga. CRS Painted HS = 20Ga. SS Brushed HP = 20Ga. SS Painted HA = 16Ga. Alum. Painted	INSET (I) or OVERLAP (O) OC = 18Ga. CRS Painted OS = 18Ga. SS Brushed OP = 18Ga. SS Painted OA = 16Ga. Alum Painted IC = 20Ga. CRS Painted IA = 16Ga. Alum Painted IB = 20Ga. SS Brushed IS = 20Ga. SS Painted	L1 = Standard	35 = 3500°K 40 = 4000°K 50 = 5000°K
	*Flange shipped with yoke	*Nominal Size. Dimensional Data on Page 2	*Recommended to be used in pairs adjacent to the patient bed. Will need to order both a Left & a Right for a complete pair.			*Subject to change. Data on Page 3. Delivered lumens are for one unit, not a pair.	

EXAM LUMEN OUTPUT*	EXAM COLOR TEMP.	CIRCUITS*	LENS	READING LIGHT*	NIGHT LIGHT	VOLTAGE
		2C				
L1 = Low L2 = Standard L3 = High	35 = 3500°K 40 = 4000°K 50 = 5000°K	2C = 2 Circuits *Ambient and Exam section will have 2 circuits unless otherwise specified. Reading and/or Night Light supplied with an additional independent circuit	A = .125 Prismatic Acrylic B = .125 Prismatic Poly. C = .156 Prismatic Poly. D = .187 Prismatic Poly. E = .125 White Frost Poly.	Blank = No Reading RI = LED Integral Light* *Reading Light is 3000°K unless otherwise specified. Controlled via additional independent circuit unless otherwise specified	Blank = No Night Light LN = Integral Night Light* *Night Light is 3500°K unless otherwise specified. Controlled via additional independent circuit unless otherwise specified	12 = 120V 27 = 277V UN = Universal (120V-277V)
*Subject to change. Data on Page 3. Delivered lumens are for one unit, not a pair.						

OPTIONS

FZ1 = Fuse (120V) FZ2 = Fuse (277V) DM = 0-10V dimming with 10-100% range DM1 = 0-10V dimming with 1-100% range EL1 = Remote Emerg. Bat. LED Low (1100-1250 lm)*	TH = Torx Head screws (with center pin) LV2 = Low Voltage Controller (Reading & Ambient)** LV3 = Low Voltage Controller (Reading, Ambient & Night Light)** 90C = 90 CRI for Ambient & Exam only * If stored, batteries should be fully recharged every six months and kept between 0°C-25°C to maintain optimal battery capacity. ** Pillow switch by others. One Low Voltage Controller is required per Pair unless otherwise specified. Leads are factory labeled.
--	---

ORDERING EXAMPLE

Sold as a single unit. Recommended to be used in pairs adjacent to patient bed, order (2) fixtures. Order a "Left" and a "Right" for a complete pair (2 separate line items). Consult factory with additional questions.

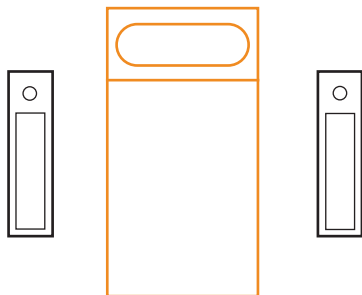

CPPG4-L
Left

CPPG4-R
Right

Notes:
 Specifications and Dimensions are subject to change without notice.
 For additional options and dimensional details please consult your New Star Lighting Representative.

PERFORMANCE DATA*

MODEL	FUNCTION	OUTPUT	LAMP TYPE	LUMENS DELIVERED	EFFICACY (lm/W)	INPUT POWER (W)	
CPP2	Ambient	Standard (Prismatic Lens)	3500°K	1100	88	12.5	
			4000°K	1150	92	12.5	
			5000°K	1200	96	12.5	
		Standard (White Frost. Lens)	3500°K	975	78	12.5	
			4000°K	1025	82	12.5	
			5000°K	1075	86	12.5	
	Exam	Low (Prismatic Lens)	Low (Prismatic Lens)	3500°K	1250	96	13
				4000°K	1300	100	13
				5000°K	1350	104	13
			Standard (Prismatic Lens)	3500°K	1700	94	18
				4000°K	1750	97	18
				5000°K	1800	100	18
		High (Prismatic Lens)	3500°K	2100	91	23	
			4000°K	2150	93	23	
			5000°K	2200	96	23	
		Low (White Frost. Lens)	Low (White Frost. Lens)	3500°K	1050	81	13
				4000°K	1100	85	13
				5000°K	1150	88	13
			Standard (White Frost. Lens)	3500°K	1450	81	18
				4000°K	1500	83	18
				5000°K	1550	86	18
		High (White Frost. Lens)	3500°K	1700	74	23	
			4000°K	1750	76	23	
			5000°K	1800	78	23	
Reading			3000°K	200	50	4	
CPP4		Ambient	Standard (Prismatic Lens)	3500°K	2200	88	25
				4000°K	2300	92	25
				5000°K	2400	96	25
			Standard (White Frost. Lens)	3500°K	1950	78	25
				4000°K	2050	82	25
	5000°K			2150	86	25	
	Exam	Low (Prismatic Lens)	Low (Prismatic Lens)	3500°K	2500	96	26
				4000°K	2600	100	26
				5000°K	2700	104	26
			Standard (Prismatic Lens)	3500°K	3400	94	36
				4000°K	3500	97	36
				5000°K	3600	100	36
		High (Prismatic Lens)	3500°K	4200	91	46	
			4000°K	4300	93	46	
			5000°K	4400	96	46	
		Low (White Frost. Lens)	Low (White Frost. Lens)	3500°K	2100	81	26
				4000°K	2200	85	26
				5000°K	2300	88	26
			Standard (White Frost. Lens)	3500°K	2900	81	36
				4000°K	3000	83	36
				5000°K	3100	86	36
		High (White Frost. Lens)	3500°K	3400	74	46	
			4000°K	3500	76	46	
			5000°K	3600	78	46	
Reading			3000°K	200	50	4	

*Data for individual unit. Data is with 80 CRI chip. LEDs are frequently updated therefore values may change without notice. Visit www.newstarlighting.com for additional information and IES files.

Notes:
Specifications and Dimensions are subject to change without notice.
For additional options and dimensional details please consult your New Star Lighting Representative.