

# NSCEU COMBO EXIT SERIES

PROJECT: \_\_\_\_\_  
 TYPE: \_\_\_\_\_  
 PRODUCT: \_\_\_\_\_  
 APPROVED BY: \_\_\_\_\_

## PRODUCT FEATURES

- Intended for vandal-prone applications including Public Areas, Schools, Locker Rooms, Corridors, Commercial Settings, and more
- Wall surface mount installation
- One 0.5W white LED per lamp head. Red and/or green legend, universal single/double face
- Fixture is certified to UL standards for Damp Locations (0°C - 40°C)
- This product is Assembled in America and complies with Buy American Act requirements

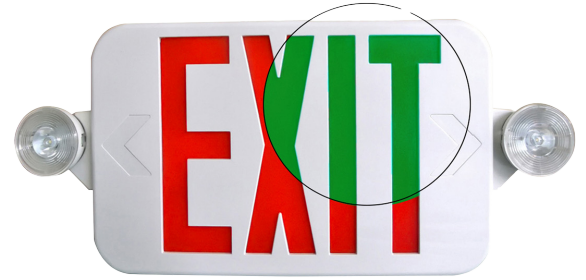

NSCEU Series

## ORDERING INFORMATION

Example: NSCEU-2RW-WH



NSCEU	2			
<b>Series</b>	<b>Face</b> 2 = Universal Single/Double Face	<b>Lettering</b> RW = Red Letters GW = Green Letters RGW = Red/Green Letters	<b>Housing Color</b> WH = White BK = Black	<b>Options</b> CUS = Custom Signage* SDT = Self-Diagnostics* RC = Remote Capacity** HL = High Lumen LED** SPV = 120/230 Volt 50/60Hz*  *Consult factory *Not available with RG units **-HL and -RC options cannot be combined. 0.5W of remote capacity available standard with -HL option



**New Star Lighting**

2225 W Pershing Rd, Chicago, IL 60609  
 (773) 847-1400  
 www.newstarlighting.com

Specifications and dimensions are subject to change without notice. For additional options and dimensional details, please consult your New Star Lighting representative.

© 2025, New Star Lighting. All rights reserved. Unauthorized duplication or distribution is prohibited.

## SPECIFICATIONS

**CONSTRUCTION:** Injection-molded 5VA flame retardant, UV-stabilized polycarbonate in white or black finish. Snap-out Chevron directional indicators. Unique all inclusive lamp, reflector and lens assembly. Optional single face or double face with snap-out Chevron directional indicators.

**ELECTRICAL:** Dual 120/277 voltage standard, optional 120/230 Volt 50/60Hz. Energy-efficient, long life Red or Green LEDs. Unique bi-color LED indicator light alerts occupant on battery condition (Green = normal, Red = check battery). Charge rate/power "ON" LED indicator light and magnetic test switch for mandated code compliance testing.

3.6V long life, rechargeable NiCd battery. Internal solid-state transfer switch automatically connects the internal battery to LED board for minimum 90-minute emergency illumination. Fully automatic solidstate, two rate charger initiates battery charging to recharge a discharged battery in 24 hours.

### ELECTRICAL OPTIONS:

**SDT:** Self-diagnostic feature performs monthly, biannual, and annual tests to ensure reliable operation and meets electrical and life safety codes.

**High Lumen (HL) option:** Provides increased center-to-center spacing (2 Watts per head).

**Remote Capacity (RC):** Remote capacity of up to 1.0 watts.

**FASTENERS:** Stainless steel Philips fasteners.

**INSTALLATION:** Thermoplastic mounting canopy included - provides top or end mount. Universal knockout pattern on backplate for wall mount.

**WARRANTY:** Five (5) year warranty on all electronics and housing. Battery prorated for five years.

**LABEL:** Fixture UL Listed for Damp Locations (0°C - 40°C). This product meets NFPA 101 Life Safety Code, NEC, OSHA, Local and State Codes. Certified to CEC under Title 20 Regulations. This product is Assembled in America and complies with the Buy American Act (BAA).

## DIMENSIONAL DATA

