

STARMED DOS +1 22-24 FLUORESCENT

SMDOSG22/SMDOSG24/SMDOSF22/SMDOSF24

SPECIFICATION FEATURES

- HOUSING:** 20 gauge formed cold rolled steel housing seam welded an ground smooth (standard). Stainless steel option available.
- FRAME:** Optional inset frame available in cold rolled steel and aluminum. Frame fastened to housing via hinge (standard).
- LENS:** Optional frame lens in clear polycarbonate. Ambient lens is white polycarbonate. Exam lens is available in clear ribbed acrylic or white frosted ribbed acrylic.
- ELECTRONICS:** Electronic instant start ballast <10% THD standard. Lamps by others.
- FINISH:** White antimicrobial powder coat finish following iron phosphate pre-treatment.



APPLICATION: Patient Room 3 Compartment Fixture, Hospitals, Examination Rooms, and more.

MOUNTING: Grid and Flange mounting available. Flange fixtures supplied with yokes for installation.

LABEL: Fixture is certified to UL standards by Intertek Testing Laboratories.



ORDERING INFORMATION

Ex: SMDOSG22-HC/ICA-214-224-RL-CA-UN

PRODUCT FAMILY	MOUNTING	NOMINAL SIZE <small>*Dimensional Data Pg. 2</small>	HOUSING	INSET (I) FRAME	FRAME LENS	AMBIENT # OF LAMPS
SMDOS	G = Grid F = Flange	22 = 2x2 24 = 2x4	HC= 20Ga. CRS (standard) HS= 20Ga. SS (Brushed) HP= 20Ga. SS (painted) HA= .050Ga. Alum. (painted)	Blank = No Frame IC= 18Ga.CRS IA= .050 Alum. (Painted)	Blank = No Lens A = .125 Clear Poly. 1 = .187 Clear Poly.	2 = 2 Lamp 3 = 3 Lamp

AMBIENT LAMP TYPE	EXAM # OF LAMPS	EXAM LAMP TYPE	READING LIGHT	EXAM LENS	VOLTAGE	OPTIONS
22: 14 = Linear 14W T5 17 = Linear 17W T8 24 = Linear 24W T5 (H.O.) 24: 28 = Linear 28W T5 32 = Linear 32W T8 54 = Linear 54W T5 (H.O.)	2 = 2 Lamp (1 per side)	22: 14 = Linear 14W T5 17 = Linear 17W T8 24 = Linear 24W T5 (H.O.) 24: 28 = Linear 28W T5 32 = Linear 32W T8 54 = Linear 54W T5 (H.O.)	B = None RL = 2 LED Lights (3000°K)Δ	CA=Clear Rib. Acrylic FA=Frosted Rib. Acrylic	12 = 120V 27 = 277V 34 = 347V ■ UN = Universal (120V-277V)	E1* AML E2* LV2Δ FZ* LV3Δ RFΔ

LV3= Low Voltage Controller Δ

KEY

E1 = Emerg. Battery Pack (650 Lumens)*
E2 = Emerg. Battery Pack (1100 Lumens)*
FZ = Fuse*
RF = (RIF) Radio Interference FilterΔ
AML = Antimicrobial Lens
(Exam only. N/A with IC or IA)

LV2 = On/Off Low Voltage Controller Δ
(Controls ambient and reading functions without dimming (on/off function only). Exam and Night Light (if specified) are on separate line voltage circuits. Must specify voltage. N/A with emergency battery.)

LV3 = Dimming Low Voltage Controller Δ
(Controls ambient function with dimming and on/off reading function. Exam and Night Light (if specified) are non-dimming and provided on separate line voltage circuits. N/A with emergency battery.)

* Cannot use with UN voltage
Δ Not available with 347V
■ Consult factory for lamp-ballast options

Notes:
Specifications and Dimensions are subject to change without notice.
For additional options and dimensional details please consult your New Star Lighting Representative.

STARMED DOS +1 22-24 FLUORESCENT

SMDOSG22/SMDOSG24/SMDOSF22/SMDOSF24



DIMENSIONAL DATA

GRID MOUNTING

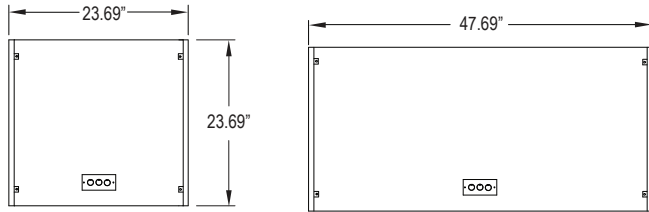
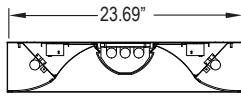

FLANGE MOUNTING

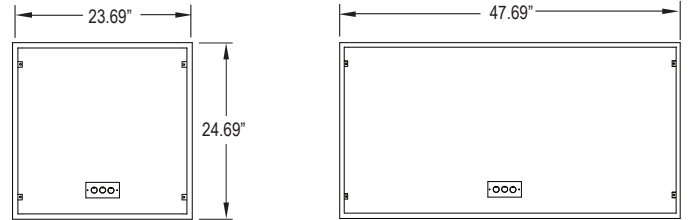
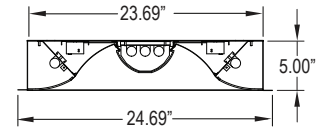

Flange Recommended Opening:

22: $24 \frac{1}{16}'' \times 23 \frac{1}{8}''$

24: $47 \frac{1}{8}'' \times 24 \frac{1}{16}''$